

# Georgia Commerce Center I

175 Brampton Road, Savannah, Georgia 31408

## AVAILABLE NOW

Direct access to Gate 3 of the Port of Savannah's Garden City Container Terminal

Excellent access to Interstate 516

Norfolk Southern rail service with internal loading

Building 100

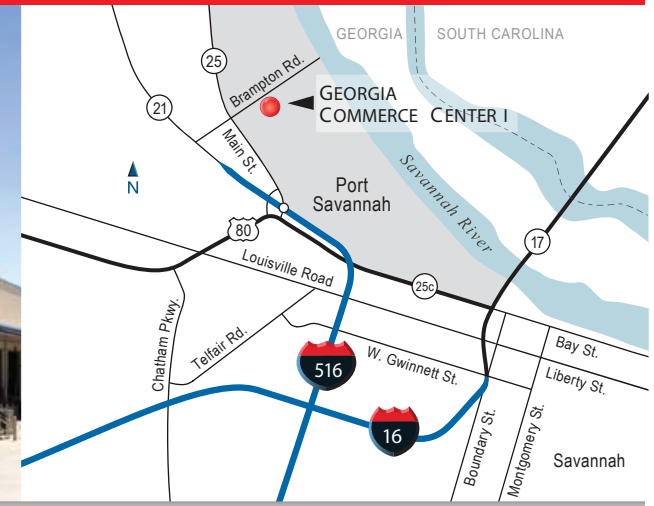

## 317,880 SF Rail-Served, Front-Load, Distribution Building

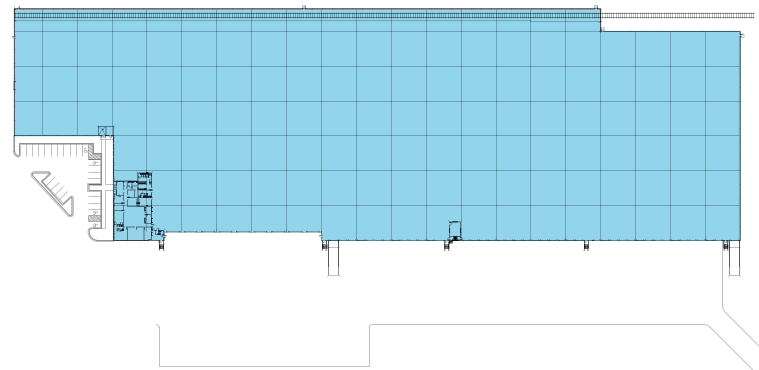

Building: 317,880 sq. ft.

Office: 4,730 sq. ft.

Floor: 8" thick, reinforced at loading bay

Ceiling Height: 32' minimum

Column Spacing: 50' wide x 50' deep

Dock Doors: (20) 9' x 10' dock high doors,

(9) 18' x 14' container high doors,

(2) 12' x 14' ramped doors, (1) 18' x 20'

grade level door, & (20) 9' x 10' knock-outs

Truck Court: 132' & 180' deep all concrete truck apron

Trailer Parking: 28 trailer spaces

Internal Rail Siding: Norfolk Southern

Construction: Architectural painted tilt-up concrete with store front

## CONTACT INFO

Tracy White/Austin McDonald

404.239.0885 voice

twhite@mcdco.com

amcdonald@mcdco.com